



INSTRUCTION BULLETIN

No. 9008464
Machine: T16
Published: 07-2011
Rev. 00

NOTE: DO NOT DISCARD the Parts List from the Instruction Bulletin. Place the Parts List in the appropriate place in the machine manual for future reference. Retaining the Parts List will make it easier to reorder individual parts and will save the cost of ordering an entire kit.

NOTE: Numbers in parenthesis () are reference numbers for parts listed in Bill of Materials.

Installation instructions for **kit number 9008115**

SYNOPSIS:

This kit contains the parts needed to replace the spray nozzle hose on T16 scrubbers.
Please follow step-by-step instructions.

SPECIAL TOOLS / CONSIDERATIONS: NONE

(Estimated time to complete: 1 hour)



PROTECT THE ENVIRONMENT

Please dispose of packaging materials, old machine components, and hazardous fluids in an environmentally safe manner according to local waste disposal regulations.

Always remember to recycle.

PREPARATION:

1. Completely empty the solution tank and the recovery tank. Refer to the Operators Manual for instructions how to empty both tanks.
2. Park the machine on a clean level surface, turn off the machine, and remove the key.

FOR SAFETY: Before leaving or servicing machine, stop on level surface, turn off machine, and remove key.

3. Disconnect the battery cables from the batteries.



WARNING: Always disconnect battery cables from machine before working on electrical components.

4. Disconnect the main wire harness from the vacuum fan assembly.
5. Remove the vacuum fan assembly from the back end of the machine. Set the vacuum fan assembly and hardware aside.

6. Remove the cable clamp securing the 35" solution supply hose to the spray nozzle assembly. Set the cable clamp aside and M8 hex screw aside. Refer to Fig. 1.
7. Disconnect the 35" solution supply hose from the spray nozzle assembly. Set the hose clamp aside. Refer to Fig. 1.
8. Remove the rotary fitting from the spray nozzle assembly. Set the rotary fitting aside. Refer to Fig. 1.
9. Use a cable tie (2) to secure the reel assembly to the mounting plate. Refer to Fig. 1.
10. Remove the spray nozzle assembly from the machine. Set the M8 hex screws aside. Refer to Fig. 1.
11. Remove the hose from the spray nozzle assembly. Set the hose clamp aside. Refer to Fig. 1.
12. Remove the spray nozzle gun and fitting from the hose. Set the spray nozzle gun and fitting aside. Discard the hose. Refer to Fig. 1.

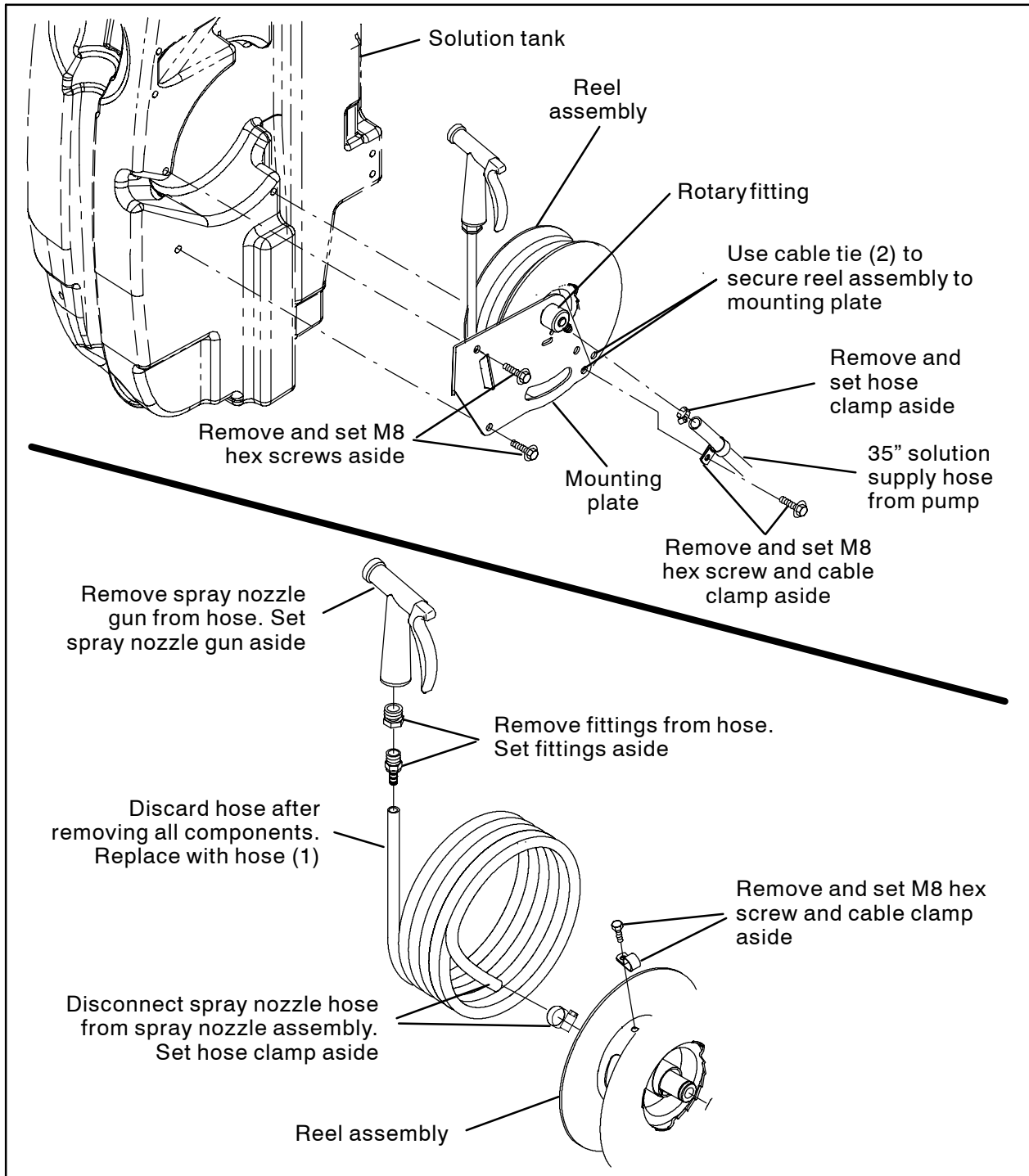

FIG. 1

INSTALLATION:

1. Install the fittings and spray nozzle gun onto the new spray hose (1). Refer to Fig. 1.

NOTE: If necessary, use a soapy solution to make installing the fitting going into the spray hose (1) easier.

2. Connect the spray hose (1) to the spray nozzle assembly. Refer to Fig. 1.
3. Use the M8 hex screw and cable clamp to secure the spray hose (1) to the spray nozzle assembly reel. Refer to Fig. 1.
4. Wrap the spray hose (1) evenly onto the reel assembly. Refer to Fig. 1.

5. Wind the spray hose (1) completely onto the reel and rotate the spray hose assembly mounting plate three complete turns clockwise to set the spring tension. Refer to Fig. 2.

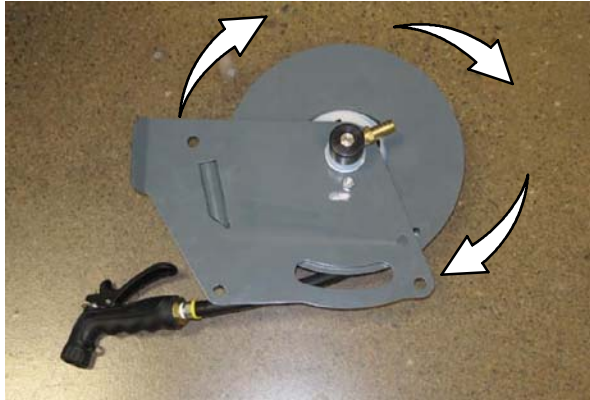

FIG. 2

6. Use two cable ties (2) to secure the reel assembly and spray hose (1) to the mounting plate. Refer to Fig. 3.

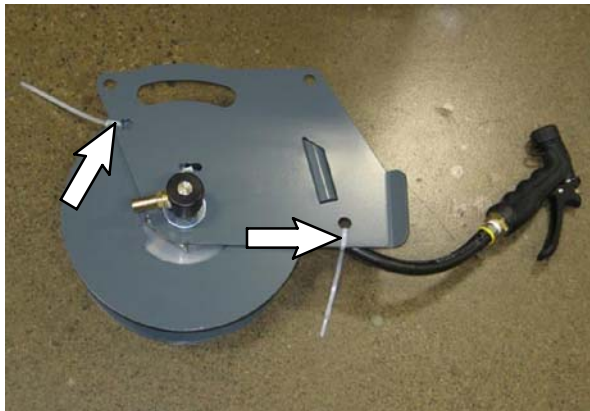

FIG. 3

NOTE: Do Not cut the cable ties (2) holding the spray hose into the spray hose reel until after the spray hose assembly is installed onto the machine. The spray hose could unwind from the spray nozzle assembly if the cable ties are cut before the spray nozzle assembly is reinstalled onto the machine, making it necessary to repeat Step 4 through Step 6 to reset the spring tension.

7. Reinstall the spray hose assembly onto the solution tank. Refer to Fig. 1.
8. Reinstall the rotary fitting onto the spray nozzle assembly. Refer to Fig. 1.
9. Use the hose clamp to reconnect the 35" solution supply hose to the rotary fitting. Refer to Fig. 1.
10. Use the cable clamp and M8 hex screw to secure the 35" solution supply hose to the spray nozzle assembly. Refer to Fig. 1.
11. Cut the cable ties (2) from the reel assembly. Refer to Fig. 1.
12. Reinstall the vacuum fan assembly onto the machine and reconnect the wire harness to the vacuum fan assembly.
13. Reconnect the battery cables to the batteries.
14. Start and test the machine. Fill the solution tank. Turn on and operate the spray nozzle to ensure it functions. Refer to the Operators Manual for instructions how to use the spray nozzle.

Bill Of Materials For Hose Kit, Replmt [T16] - 9008115

	Tennant			
Ref.	Part No.	Description		Qty.
▽	9008115	Hose Kit, Replmt [T16]		1
▲	1 1061087	Hose, Rbr, 0.38ID, Bulk, Blk [Push-Lok]		1
▲	2 44961	Tie, Cable, Nyl, 14.5L .30W 4.0 Max D		3

TENNANT COMPANY
P. O. Box 1452
Minneapolis, MN 55440-1452